

Preserving a Hybrid Collection: the King's Cross Station Design Archives

DPC Briefing: Preserving Computer-aided Design, 26th July 2013



Fig 1

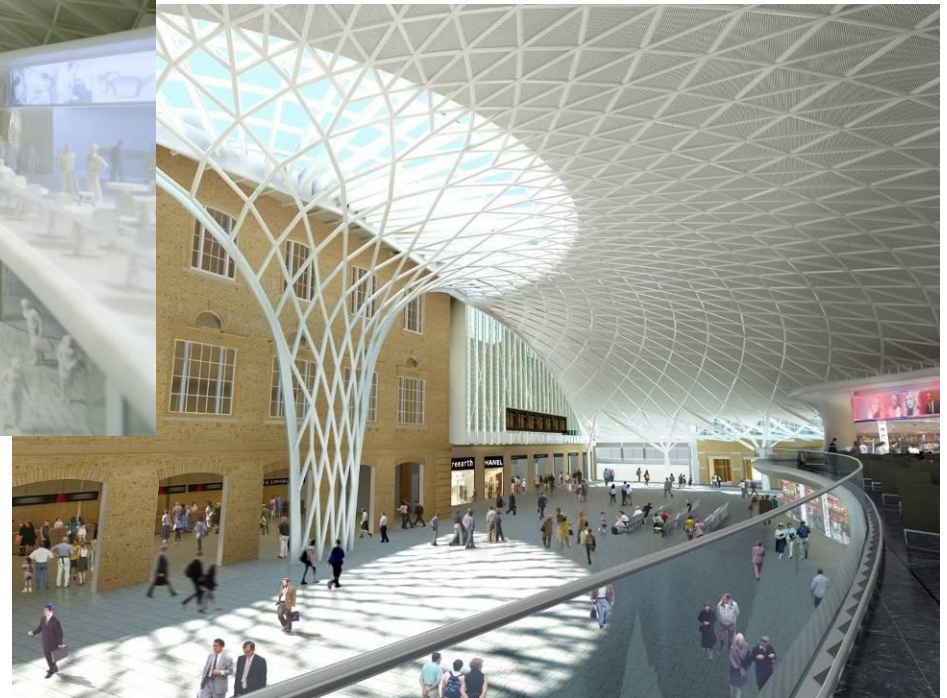

Fig 2

Kurt Helfrich
Chief Archivist & Collections Manager
British Architectural Library

Architectural Practice Goes Virtual

Aberrant Architecture, London



Fig 5

2010



Fig 6

2013



Fig 7

RIBA 

King's Cross Central 21st-century London Gateway 2006 -

King's Cross Station
St Pancras Station (Eurostar)
St Pancras Renaissance Hotel
Great Northern Hotel

67 acre Brownfield site
25 new office buildings
2000 new homes
Refurbishment of 20 historic buildings
20 new streets
10 new public spaces
3 new bridges
University of the Arts complex
Google

Own postcode: **N1C**

Argent Group PLC
London and Continental Railways

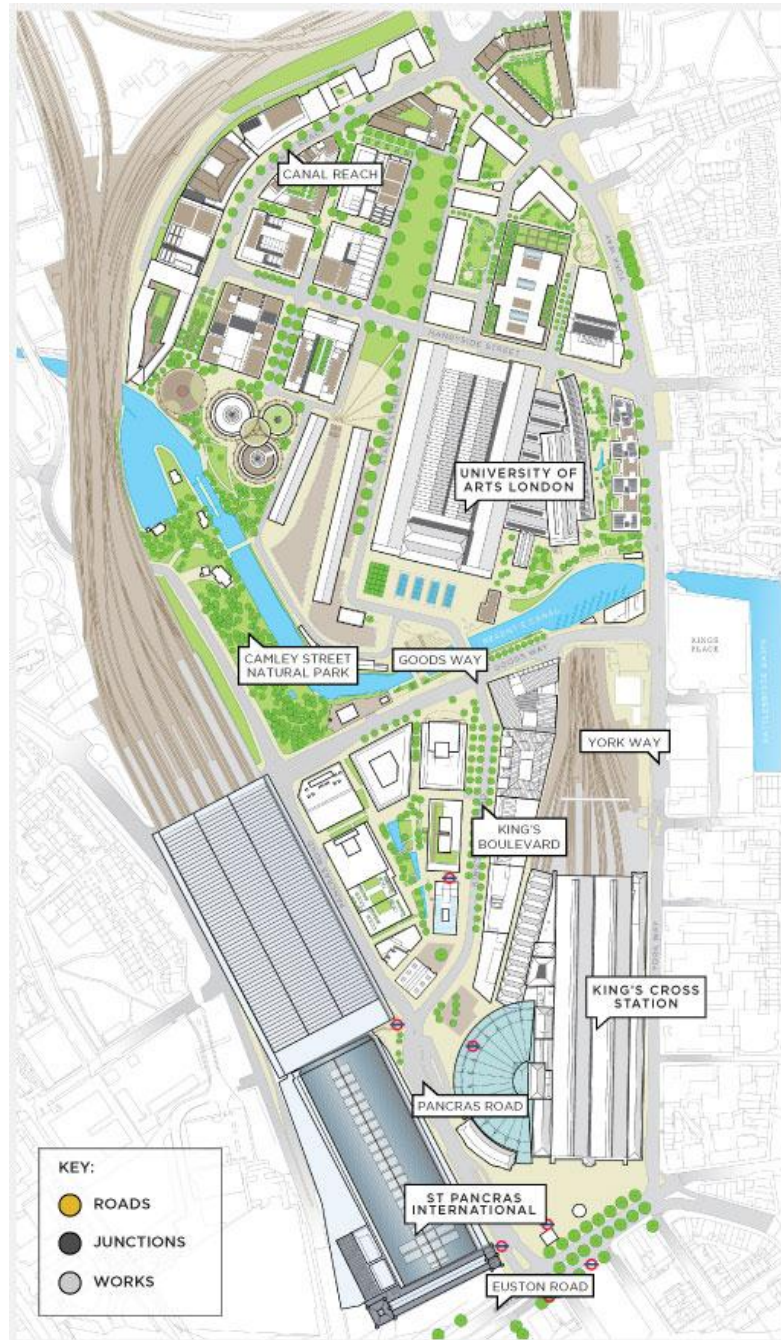

Fig 8

King's Cross: Regenerating a London Landmark

V&A + RIBA Architecture Partnership Display (May – October 2012)



Fig 9



Fig 10



Fig 11

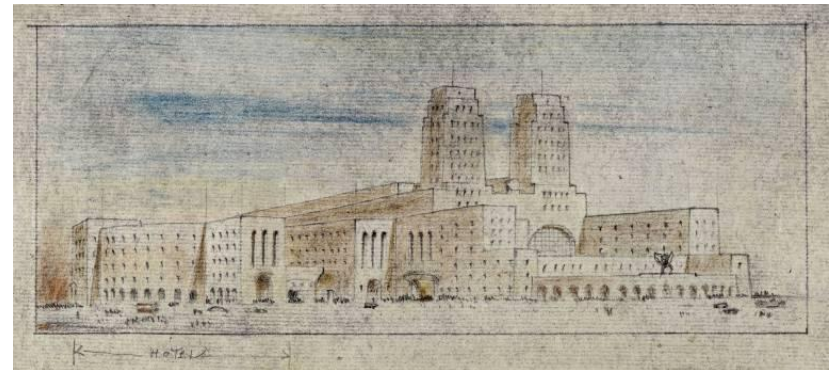
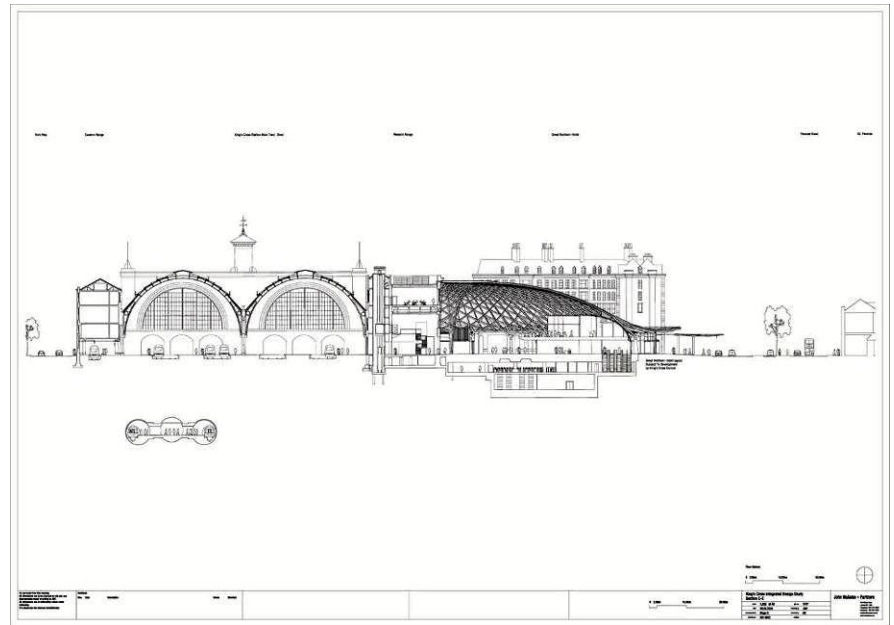

Fig 12

Architectural Records: Hybrid Collections



Fig 13



**King's Cross Station design archives
John McAslan + Partners
1997-2013**

Fig 15



Fig 14

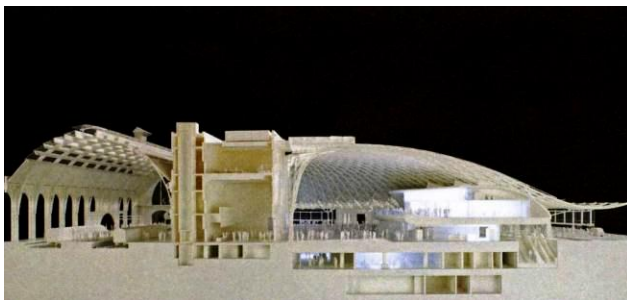

Fig 16



Fig 17



Fig 18

RIBA 

London King's Cross



Fig 19



Fig 20

Train Station (John McAslan + Partners) opened **March 2012**

Great Northern Hotel (Archer Humphries Architects) opened **April 2013**

King's Cross Square (Stanton Williams Architects) opening **autumn 2013**

King's Cross Station Project Design

Archiving Components

Audit and Selection

Review with External Stakeholders

Deed of Gift

Transfer of Materials

Cataloguing and Dissemination

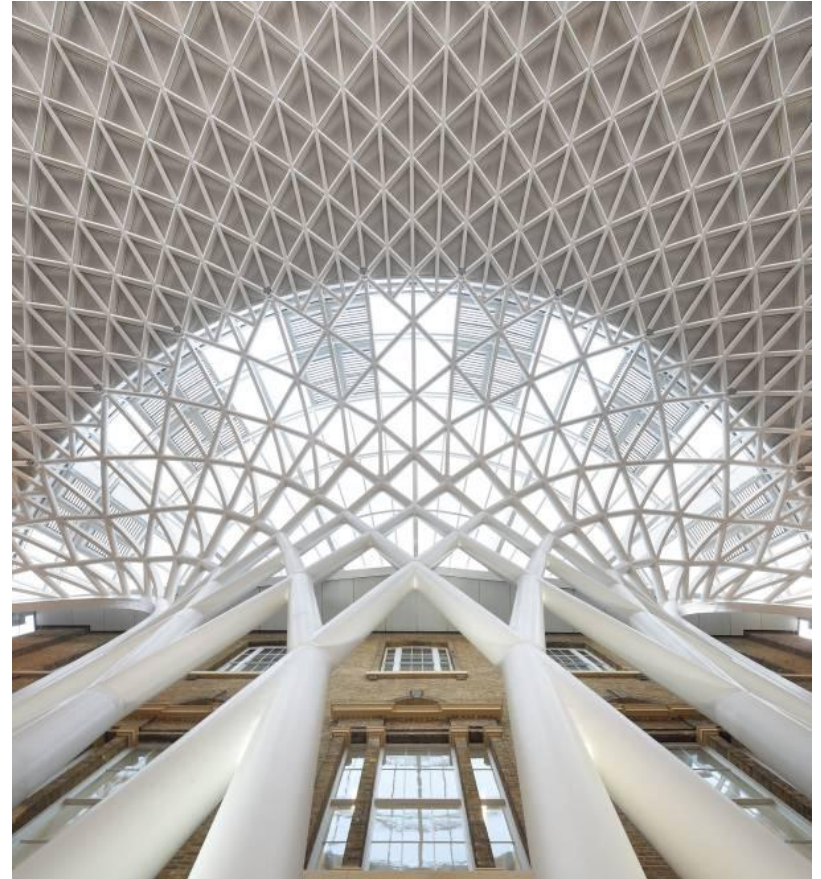

Fig 21

Audit and Selection

Appraisal is the core, critical function of archival work. What archivists need to do now is to develop new versions of appraisal approaches to be applied effectively to the digital documentary universe...Richard J. Cox (2011)

John McAslan + Partners King's Cross Project Materials (1997-2013)

1. Project Drawings (negatives, blueprints, hardcopies, 35mm positives transfers, DXF, DWG, DGN, PDF)
2. Project Models (actual, photographs)
3. Project Visualizations (JPEGs, TIFFS)
4. Project Animations (MPEG, AVI)
5. Project Reports (hardcopies, PDF)
6. Project Building Samples (actual, photographs)
7. Project Photographs (hardcopies, JPEG, PDF)
8. Project Films (DVD)
9. Project Presentations (PowerPoint, PDF)

Fig 22

APPRAISAL GRID	permanent	retain many for documentation	retain a few for examples	destroy or transfer*	case-by-case	reformat
OFFICE RECORDS						
minutes of meetings		x				
financial records				x		
marketing records	x					
personnel records				x		
awards	x					
correspondence with publishers	x					
clip files/tear sheets	x					
DESIGN DEVELOPMENT						
sketches	x					
schematics	x					
presentation drawings	x					
Computer Aided Design (CAD)	x					x
CONSTRUCTION DRAWINGS						
final drawings/record set	x					
site plans	x					
elevations	x					
sections	x					
floor plans	x					
bid sets				x		
field sets				x		
field sets - if annotated	x					x
electrical plans *				x		
mechanical plans *				x		
plumbing plans *				x		
structural plans	x					
as-builts / design build	x					
reproduction masters						x
details					x	
PROJECT FILES						
photographs	x					
slides	x					
videos	x					x
negatives	x					
specifications - building		x				
specifications** - plumbing, electrical				x		
contracts		x				
correspondence with clients		x				
correspondence with contractors/subs		x				
legal documents	x					
daily reports			x			
weekly reports			x			
monthly reports		x				
consultant reports			x			
engineer reports			x			
tenant improvements		x				
architect alterations	x					
product samples					x	
punch list		x				
models			x			
transmittals				x		
change orders			x			
bid documents			x			
telephone notes		x				
financial statements/billing			x			
POST-CONSTRUCTION RECORDS						
public response	x					
publications	x					

* return to firm or give to building owners

** electrical, mechanical, plumbing plans and specifications - you may choose to retain these for some residences but not for major projects

Review with External Stakeholders

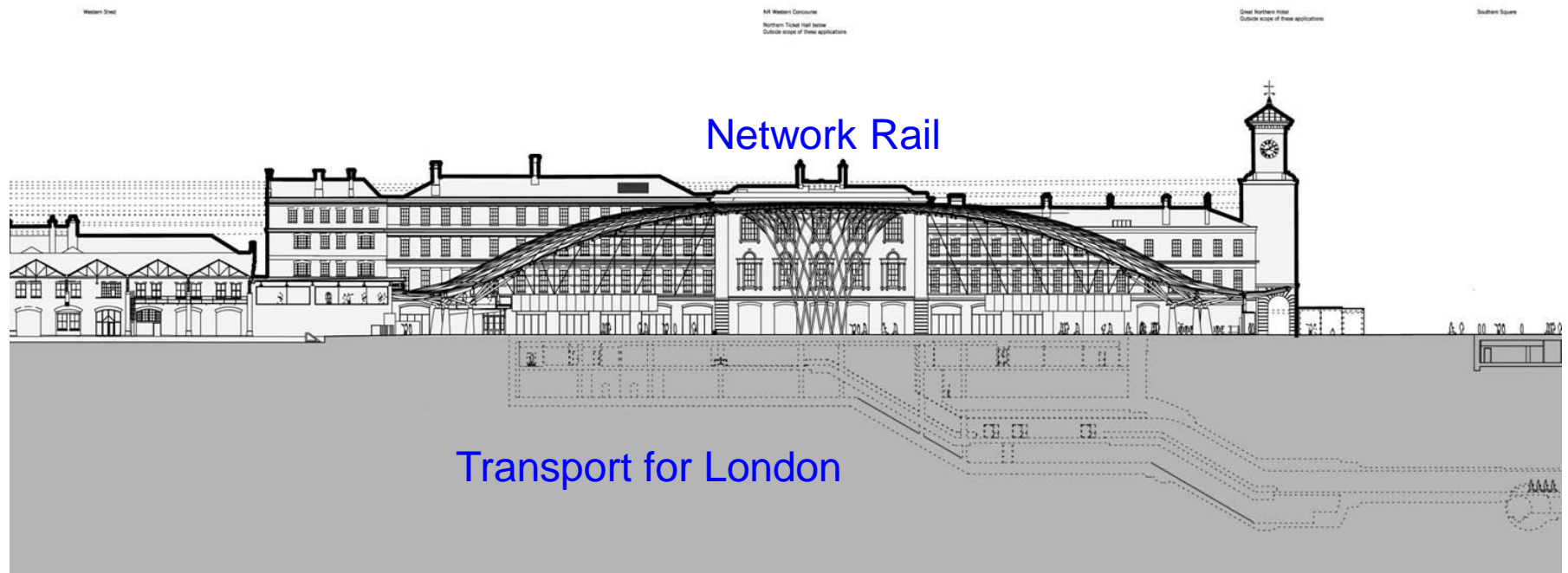

Fig 23

Deed of Gift/Cataloguing

<http://www.digitalcurationervices.org/aims/>

The screenshot shows a web browser window displaying the 'AIMS White Paper' page. The browser's address bar shows the URL 'www.digitalcurationervices.org/aims/white-paper/'. The page header includes the 'UNIVERSITY OF VIRGINIA LIBRARY Digital Curation Services' logo and a search bar. The main content area is titled 'AIMS White Paper' and contains a paragraph explaining the project's evolution and a link to download the white paper. A sidebar on the right lists various services and resources, including 'REQUEST DIGITIZATION of Special Collections Materials Using Our Online Request Form', 'News & Events', 'People', 'Digitization Services', 'Digital Stewardship Services', 'Portfolio', 'Sustaining Digital Scholarship', and 'AIMS'. At the bottom of the sidebar are social media icons for Facebook, YouTube, and Twitter.

AIMS White Paper | University of Virginia Library Digital Curation Services - Mozilla Firefox

File Edit View History Bookmarks Tools Help

AIMS White Paper | University of Virginia Libra...

www.digitalcurationervices.org/aims/white-paper/

Most Visited Service update now Amazon UK Holiday Rentals world... Archives for London | Gmail - Inbox - kurtgh... M25 Consortium of Ac... ArtsJournal: Daily Arts ... Washington Post - Poli...

Digital Curation Services Home U.Va. Home U.Va. Library Search Site

UNIVERSITY OF VIRGINIA LIBRARY
Digital Curation Services

UNIVERSITY OF VIRGINIA LIBRARY

AIMS White Paper

AIMS White Paper

The AIMS project evolved around a common need among the project partners — and most libraries and archives — to identify a methodology or continuous framework for stewarding born-digital archival materials. These materials have been slowly accumulating in archival backlogs for years but are rapidly growing as more contemporary collections are accessioned. Alongside the many and complex technological requirements, the challenges of stewarding born-digital material demand new strategies as well as a redefinition of archival workflows. If the archival profession aims to preserve and manage born-digital material to standards matching those of paper-based collections, a broader and deeper understanding of these issues must be developed, and this understanding must be incorporated into training of new archival professionals, professional development programs, and continuing education.

Into this climate, the AIMS partners proposed an inter-institutional framework for stewarding born-digital content. The AIMS partners realized that they could not solve all problems associated with born-digital materials but decided to focus their attention on professional practice defined by archival principles and by the current state of collections at the partner institutions. The AIMS Framework was developed to define good practice in terms of archival tasks and objectives necessary for success. The Framework, as defined in the White Paper found below, presents a practical approach but also a recognition that there is no single solution for many of the issues that institutions face when dealing with born-digital collections. Instead, the AIMS project partners developed this framework as a further step towards best practice for the profession.

Download the White Paper below and feel free to join in the conversation over at [The Born Digital Archives blog](#).

AIMS White Paper

- Text
 - With Appendices ([US-letter version](#) | [UK-A4 version](#))
 - Without Appendices([US-letter version](#) | [UK-A4 version](#))
- Appendices only

REQUEST DIGITIZATION of Special Collections Materials Using Our [Online Request Form](#)

News & Events

People

Digitization Services

Digital Stewardship Services

Portfolio

Sustaining Digital Scholarship

AIMS



Fig 24

King's Cross Station Design Archives: Challenges

Project is **Live**: Legal Liability

Security/Sensitive data

Licensing/Intellectual Property
Ownership and Transfer

JMP: Records Management
system run by ICT: short-term
rather than long-term perspective

RIBA: appraisal how to decide
what is important: historical,
aesthetic, research values. Design
Process only?

RIBA: DAMS and ingest software

RIBA: staffing with specialist
skills—ideally practiced-based
with archives training

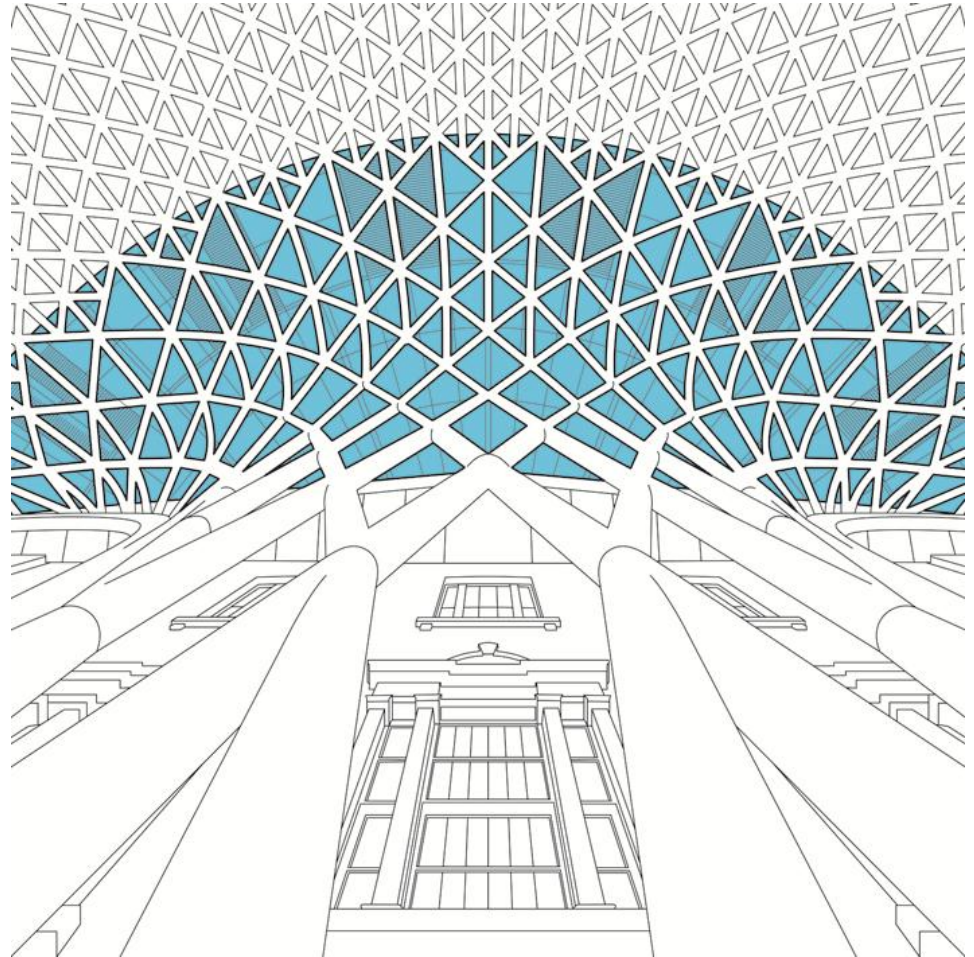

Fig 25

© Robin Farquhar for People Will Always Need Plates (2012)
JPEG

King's Cross Station Design Archives

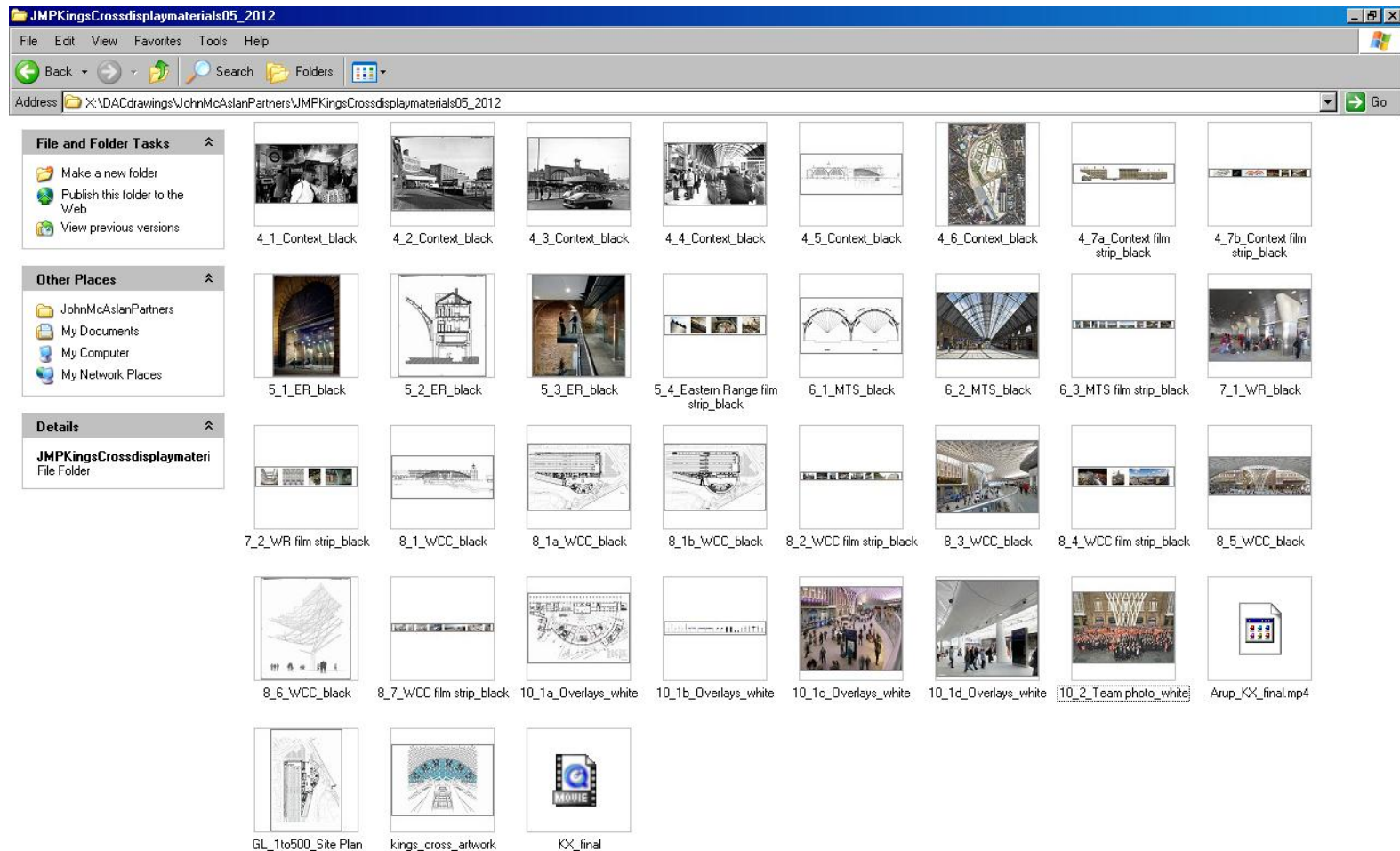
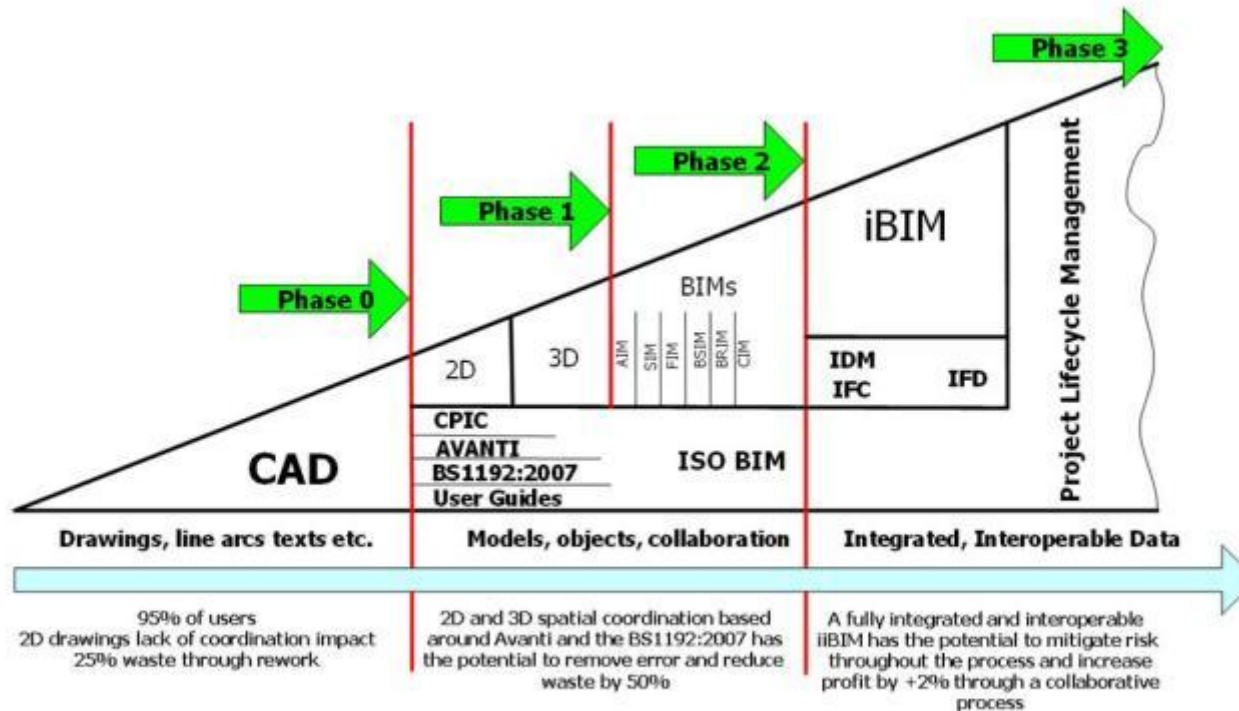

Fig 26

Conclusion

“...the full potential of digital technology will only be realized when it is used, not just for abstract or static form-making, as is the current fashion, but as an *instrument of integration* across the entire range of environmental design, production, and use.” Chris Abel 2004



© M. Bew and M. Richards 2008

Fig 27
Keith Snook
*Drawing is Dead –
Long Live Modelling*
RIBA Research Paper
2009



Fig 28

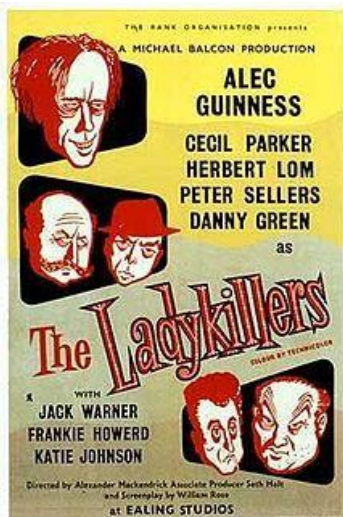

Fig 29

King's Cross: Virtual Resource

Argent Group
Network Rail
TfL
RIBA
Borough of Camden
English Heritage
Museum of London
LMA
BFI
University of the Arts

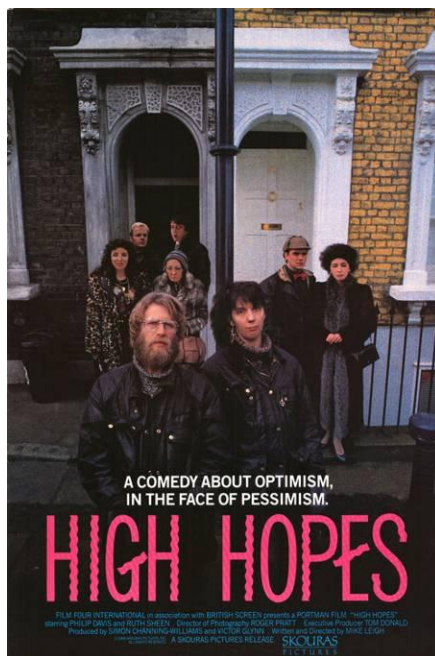

Fig 30

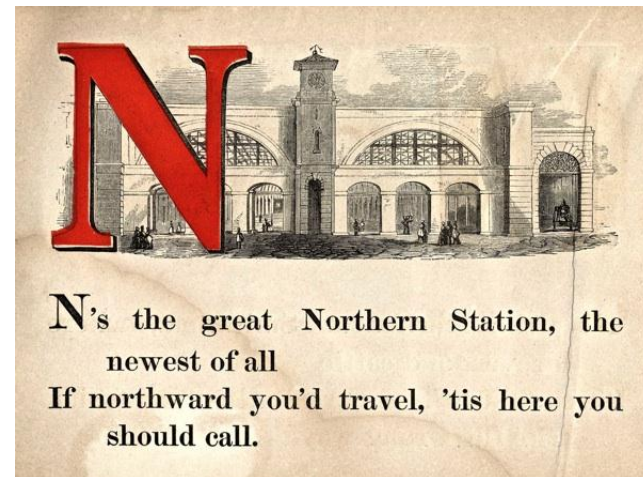

Fig 31



Fig 32

RIBA 

kurt.helfrich@riba.org

Image Credits:

Figs 1,2,3,13,14,15,16,17,21,22,23 © John McAslan + Partners

Fig 4 © King's Cross Central Limited Partnership

Figs 5,6,7 © Aberrant Architecture

Fig 8 © King's Cross Central Limited Partnership

Figs 9,10,11,12,26 © Royal Institute of British Architects

Fig 13 © Cecil Balmond/ARUP

Fig 18,28 © Getty Images

Fig 19 © Stanton Williams Architects

Fig 20 © author

Fig 22 © Society of American Archivists

Fig 24 © Rector and Visitors of the University of Virginia

Fig 25 © Robin Farquhar/people will always need plates

Fig 27 © M. Bew and M. Richards

Figs 29, 30 British Film Institute

Fig 31 © Exclusivepix

Fig 32 © Transport for London Museum